

Doven desk lamp

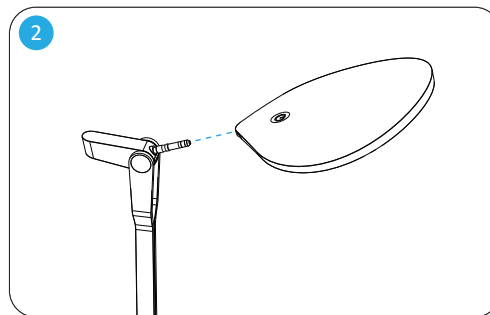

Assembly Instructions

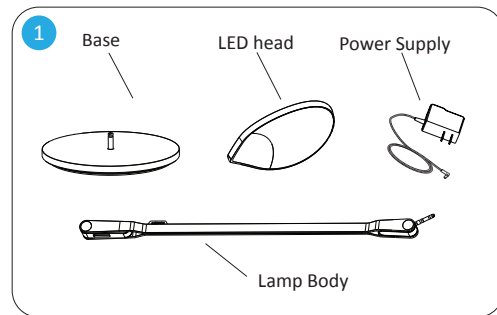

Attach the LED head to the lamp body

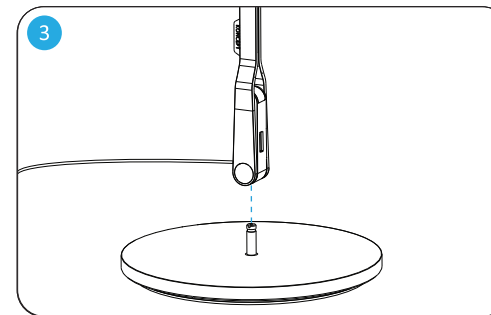

Push the lamp body down onto the base pin and click into place. Plug transformer into the lamp

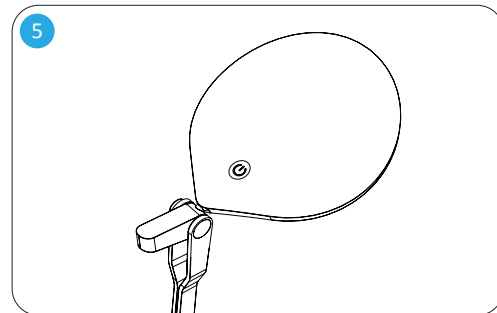
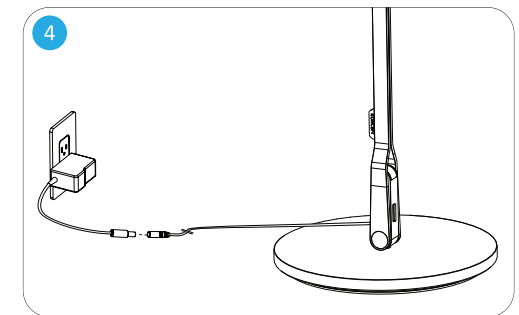

Touch the button to turn on & off, hold it to dim / brighten the light.

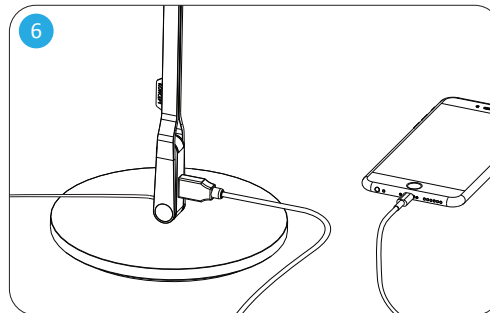

Charge your USB device with the built-in 1.0A USB port. (Doven Pro: USB port outputs 2.0A)

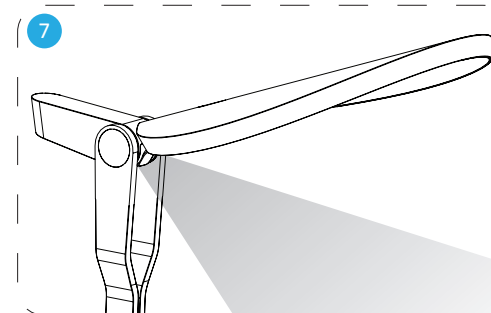

[Doven Pro only] Built-in occupancy sensor turns lamp off if no motion is detected for 15 minutes. When motion is detected, the lamp turns on at the last brightness setting.

To enable/disable the occupancy sensor: press and hold the dimmer button for 10 seconds. The light flashes 3 times to indicate that the feature is enabled. The light flashes 1 time to indicate that the feature is disabled.

Warnings



Warning: To reduce the risk of fire, electric shock or injury:

- Do not use near water
- Do not handle plug or appliance with wet hands
- Do not stare directly at LEDs



Overheating may result in reduced LED lifespan:

- Keep out of direct sunlight
- Remove plastic bag from lamp before use
- Recommended ambient temperature: under 77 °F



Do not use an external dimmer. Doing so may cause damage to the product.

Specifications

Model	SPY
Light Color	Warm White
Color Temperature	3500 K
Brightness Adjustability	Continuous

iMovR
14110 NE 21st Street
Bellevue, WA 98007
(888) 208-6770 or
(425) 999-3550

Customer Support:
customer@iMovR.com

Web Address:
www.imovr.com